

# SpeedTips & SpeedTricks

## Installing SpeedTherm underfloor heating

**1** Read the **installation instructions** and watch the installation instruction videos of the SpeedTherm system on YouTube.

**2** Consult your own layout plan as a general guide to see how to lay the EPS boards and AluTherm profiles in the room.

**3** The easiest way to install the SpeedTherm system is to do so one group at a time.

**4** Use an AluTherm profile as a ruler to **cut an EPS board straight**.

**5** **When cutting** an AluTherm profile to size, cut to either side of the radius. Then break off over your knee and fold any sharp ends under.

**6** Use an AluTherm profile to **connect two EPS plates** to each other. This helps keeping the boards in place.

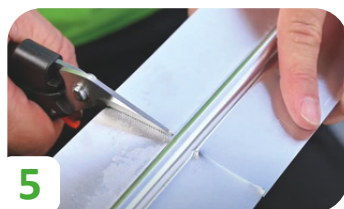
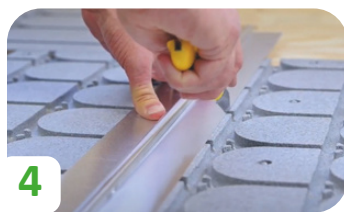
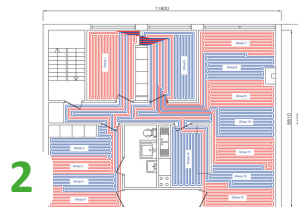

# SpeeTips & SpeeTricks

## Installing SpeeTherm underfloor heating

**7** Never let two AluTherm profiles **overlap**. Leave about 1mm of space between two ends.

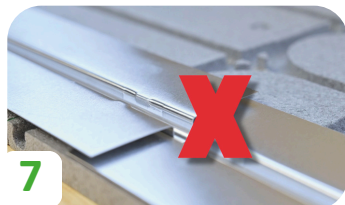

**8** When placing the AluTherm profiles, keep about 5cm of space free in places where bends are made.



**9** As soon as you start laying the AluTherm profiles, you create **recognition patterns**. A skyscraper and a staircase pattern.

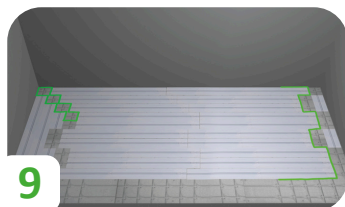

**10** When burning **extra bends**, use a round shape such as a PVC pipe with a diameter of 10cm as an aid for an optimal result.



**11** When there are not enough slits, more can be made with an EPS burner. You can cover this slit and SpeeTube heating pipe with an AluTherm profile to achieve the desired conduction.



**12** The SpeeTube heating pipe is marked with a length indication every metre. These can be used to check whether the correct number of metres have been installed.